

# INSTALLATION MANUAL



## Agra-GPS MasseySwather-JD Bridge for Massey 99xx swathers

Version 1.0  
Revision A  
July 2019

Contact information  
Agra-GPS Ltd.  
Box 2585  
Stony Plain, AB  
T7Z 1X9  
CANADA  
001 780 990 4052 Phone  
[www.agra-gps.com](http://www.agra-gps.com)

#### Release Notice

This is the July 2019 release (Revision A) of the MasseySwather-JD Bridge Installation Manual.

### **Disclaimer**

While every effort has been made to ensure the accuracy of this document, Agra-GPS Ltd assumes no responsibility for omissions and errors. Nor is any liability assumed for damages resulting from the use of information contained herein. Agra-GPS Ltd shall not be responsible or liable for incidental or consequential damages or a loss of anticipated benefits or profits, work stoppage or loss, or impairment of data arising out of the use, or inability to use, this system or any of its components.

**DO NOT USE THE MasseySwather-JD Bridge IF YOU DISAGREE WITH THE DISCLAIMER.**

## **Important Safety Information**

Read this manual and the operation and safety instructions carefully before installing the MasseySwather-JD Bridge.

- Follow all safety information presented within this manual.
- If you require assistance with any portion of the installation or service of your equipment, contact your Agra-GPS for support.
- Follow all safety labels affixed to the system components. Be sure to keep safety labels in good condition and replace any missing or damaged labels. To obtain replacements for missing or damaged safety labels, contact Agra-GPS.

When operating the machine after installing the MasseySwather-JD Bridge, observe the following safety measures:

- Be alert and away of surroundings.
- Do not operate the MasseySwather-JD Bridge system while under the influence of alcohol or an illegal substance.
- Remain in the operator's position in the machine at all times MasseySwather-JD Bridge system is engaged.
- Determine and remain a safe working distance from other individuals. The operator is responsible for disabling the MasseySwather-JD Bridge system when the safe working distance has been diminished.
- Ensure the MasseySwather-JD Bridge is disabled prior to starting any maintenance work on the machine or parts of the MasseySwather-JD Bridge system.
- Follow all safety instructions from the MasseySwather system as well as the JD system!
- The MasseySwather-JD Bridge must only be used in the field, never on the street!

## **Electrical Safety**

- Always verify that the power leads are connected to the correct polarity as marked. Reversing the power leads could cause severe damage to the equipment.
- Verify that all cables and connectors are not going over sharp edges and are not pinned, as this could cause power shortages and/or malfunctions.

## **Introduction**

Congratulations on your purchase of the MasseySwather-JD Bridge. The MasseySwather-JD Bridge is designed to bridge the communication between a Massey swather (Autoguide ready) and a John Deere display (2600, 2630 or 4640). This allows a JD display to create maps in the John Deere format and also provides autosteer.

The operator used the JD display to create AB-lines. The current position is determined by a John Deere receiver and all this information is used by the MasseySwather-JD Bridge to create steering instructions for the swather. All conditions for autosteer such as minimum speed, steering enabled etc. must be met by the MasseySwather system before the autosteer engage option in the swather can be activated.

### **NOTICE**

This manual is not intended to replace the manuals for the MasseySwather or the John Deere system. The operator must read and understand the manuals and instructions of these systems, before using the MasseySwather-JD Bridge.

## **Step 1: Mounting the MasseySwather-JD Bridge**

The MasseySwather-JD Bridge is installed right of the driver seat.

Remove the big plastic cover to the right of the seat. You will see the fuse box and other components below.

This compartment has lots of space to mount your AgraGPS-JD Bridge.



Connect the large round diagnostic port connector to the LEFT diagnostic port in the back of the compartment.



Locate the connector LCH-C225 on the forward side of the round fuse box and disconnect it.



Insert the power adapter cable with the single purple wire here. This connector provides switched 12V power to the Bridge and JD components.





## Step 2: Mounting the JD receiver

The John Deere GPS receiver **MUST** be mounted at the front of the cab.

AGCO, unlike with their 97xx or 98xx swathers, have not provided a suitable mount option at the front of their cab, so creating a solid mount at the front of the cab will be the most challenging aspect of this installation.



Use the provided adapter cable to connect the 12-pin deutsch of the JD GPS receiver with the 12-pin deutsch of the AGCO roof cable.

It comes out at the backside of the cab.

NOTE: The picture does NOT show a suitable mount, as the receiver is resting on the plastic roof. The roof material is too thin for a permanent placement of the JD GPS receiver.



## Operating notes for the AgraGPS -AGCO Swather JD Bridge

While your display and Bridge power up with the key power, the JD GPS receiver does not. Press the button located at the top right side in the cab to power your JD GPS receiver.



For autosteer activation you must follow the "normal" JD steps to be autosteer ready:

- create an AB-line
- Move from "Steer OFF" to "Steer ON" on the JD display.

Your machine must also be in "autosteer ready" mode, which means you must have a field gear selected, drive at a minimum speed and have moved your steering wheel at least once after engine start.

The autosteer is then enabled by pressing the built-in resume button in your handle. (top center).

Autosteer settings can be tweaked within the JD display.



## ISO Application

The MasseySwather bridge comes with an ISO application that will be loaded onto the John Deere monitor. The app should automatically store itself on the monitor after the first few minutes of the initial startup. On subsequent runs the app will load itself from memory as soon as possible. The MasseySwather app includes:

- Option to change work recording mode
- Option to change the machine type
- Option to disable throttle autosteer engage button
- Help page

Where to find the MasseySwather ISO application on the John Deere monitor:

- On a John Deere 4640 the application will be loaded in the ISOBus VT section on the main page of the display.



- On John Deere 1800, 2600, 2630 the application will be shown in the side menu of the John Deere display. The side menu is opened by clicking the button on the bottom right of the display.

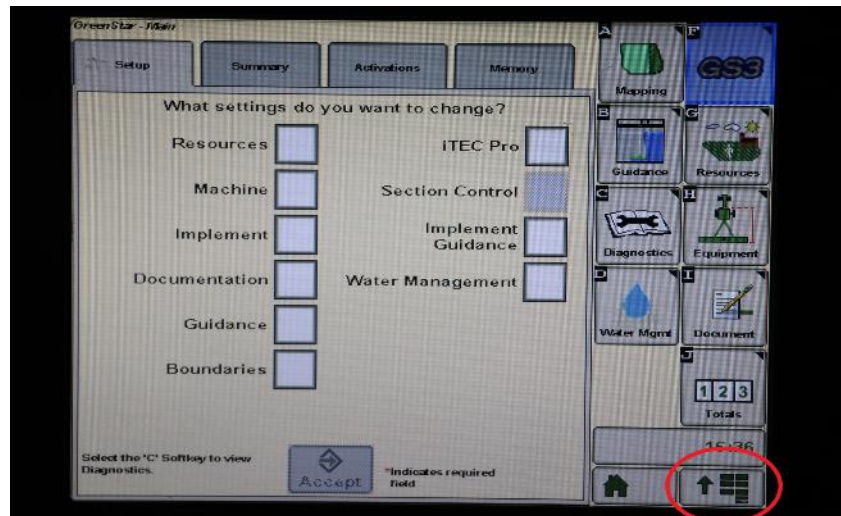

- **NOTE:** John Deere 1800 and 2600 monitors do not show a loading bar for ISO applications, while 2630 and 4640 monitors do.



If the ISO application is not loaded:

- Try clearing the monitor's memory. On 2630 monitors this can be done in the Message Center in the side menu. Go to the Cleanup tab, check controllers, then Begin Cleanup. On 4640 monitors this can be done in the info page of the ISOBus VT. Navigate to the ISOBus VT window and click the info button at the top of the page, then press Clean Up ISO Bus VT.
- Do a hard reset of the John Deere monitor (Unplug it, then plug it back in).
- Do a full restart of the machine. Remember the app may take a few minutes to load.

## **Step 6: Additional information for MasseySwather-JD Bridge**

Important – Currently, the tractor machine type must be selected in the John Deere monitor for proper work recording while using the MasseySwather-JD bridge.

Work recording – To enable work recording, select hydraulic one in the SVC page of the John Deere monitor as the work recording trigger. Then select how the user wants to enable work recording in the Agra-GPS ISO application. 'On Resume' means that work recording will start whenever autotrac guidance is enabled. 'Header' means that the user will select a work recording height in the Agra-GPS ISO application, and work recording will start when the header height goes below that height.